

# GREASE DUCT ENCLOSURE

**Enclosure:** Each layer of blanket is installed with all joints overlapped a minimum of 3 inches, both circumferentially and longitudinally. The joints of the second layer must be offset a minimum of 3 inches, from the joints of the first layer. Each layer is held in place with filament tape, placed circumferentially around the duct, 1.5 inches from the edge of each piece of blanket material and spaced 10.5 inches on center. All cut or exposed edges of insulation blanket must be sealed with aluminum tape. The blanket materials should not be compressed during installation. Steel banding is used to hold the outer layer in place. The bands are placed circumferentially 1.5 inches from the edges of the blanket and are spaced 10.5 inches on center. The tension of the banding material must be

sufficient to hold the blanket materials firmly in place, without compressing the blanket.

For duct dimensions greater than 24 inches No. 12 gage steel insulation pins, long enough to extend through all the layers of blanket material, are welded in columns nominally spaced 12 inches apart and rows nominally 10.5 inches apart. In the transition area, the pin spacing for all columns and rows is nominally 8 inches. Pins are spaced a minimum of 3 inches from the edges of the duct and 2 inches in the transition areas. The insulation blankets are locked in place over the pins with 1.5 inch diameter speed clips.



ER-6066

WRAPID 24" x 48" Maximum Duct Size  
Two Layer ICBO ER-6066  
AC101 System

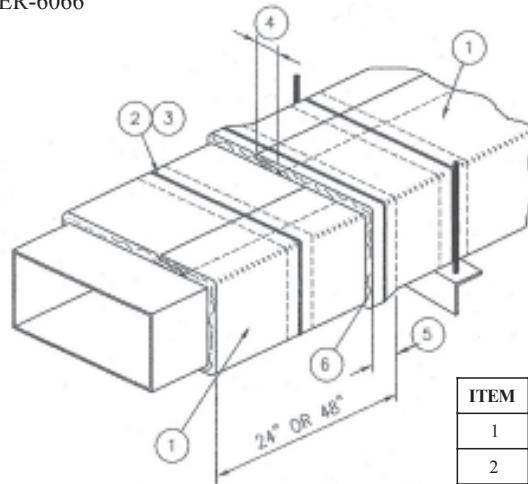

ITEM	DESCRIPTION
1	WRAPID-Two Layers
2	FILAMENT TAPE
3	STAINLESS STEEL BANDING
4	3" MINIMUM OVERLAP
5	3" LONGITUDINAL OVERLAP
6	ALUMINUM TAPE OVER OPEN FIBER

## INSTALLATION GUIDE

8050 Highland Pointe Parkway • Macedonia, Ohio • 800-863-5400 • Fax: 330-468-6610 • www.etschaefer.com

# ICBO

**ETS Schaefer**

# GREASE DUCT ACCESS DOOR

## INSTALLATION GUIDE

8050 Highland Pointe Parkway • Macedonia, Ohio • 800-863-5400 • Fax: 330-468-6610 • www.etschaefer.com

**Grease duct access doors:** The access doors are protected with three layers of 2-inch thick blanket installed as illustrated below. A gasket of 0.5-inch thick blanket is installed between the duct and the door cover. Each access door assembly has four 0.5-inch diameter threaded rods, one welded to each corner of the access door opening. The rods are between 5 and 7 inches long. 6-inch long hollow steel tubes fit over the threaded rods and act as protective sleeves for the blanket material when the door is fastened. Five steel insulation pins are welded to the access door cover, one in each corner approximately 1-inch from the corner, and one at the center of the door cover. Each layer of the blanket material is installed over the threaded rods and pins with each successive layer cut to size, resulting in the perimeter joint extending one inch beyond the layer below. The blanket layers are held in place by 1.5-inch diameter steel speed washers over the insulation pins and

wing nuts for the threaded rod. Access door labels must be applied to all access doors.

**Duct Support:** Horizontal duct support systems do not require WRAPID blanket when constructed using a minimum 0.5" diameter all thread steel rod and 2-inch by 2-inch by .25" steel angle spaced a maximum 60" on center. A minimum 2" is required between the edge of the WRAPID material and the steel rod.

Vertical assemblies are supported with minimum 1.5-inch by 1.5-inch by .25-inch steel angle brackets, located on opposite sides of the duct on the top and bottom of each floor-ceiling assembly. The supports are attached to the duct with welds.



ER-6066



1	Access Door Opening
2	Frame Welded to Duct
3	Threaded Rods
4	Access Door Cover Panel
5	Insulation Pins welded to Cover
6	First Layer WRAPID
7	Second Layer WRAPID
8	Third Layer WRAPID
9	Speed Clips with Washers
10	Cut Edges sealed with Aluminum Tape
11	Hollow Steel Tubing, 5/16" ID (optional)
12	1/4" Diameter Wing Nuts and Washers

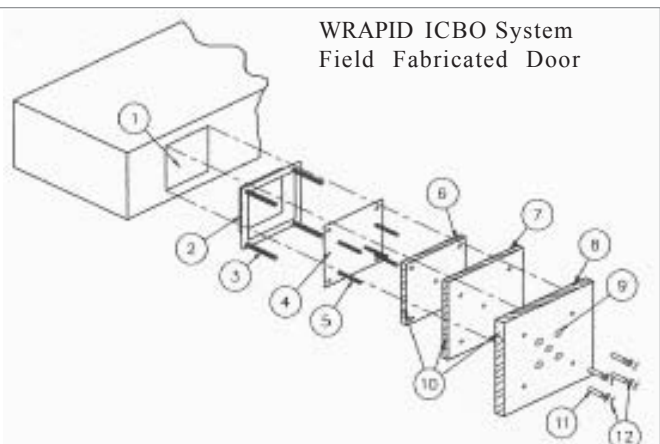

# ICBO

ETS Schaefer

# GREASE DUCT FIRESTOP SYSTEM

## INSTALLATION GUIDE

8050 Highland Pointe Parkway • Macedonia, Ohio • 800-863-5400 • Fax: 330-468-6610 • www.etschaefer.com

**Through-penetrations:** Floor-ceiling-wall assemblies-2 hour F and T-rated through-penetration Fire-stop assembly: For floor assemblies greater than or equal to 4.5" the annular space of the penetration is to be protected as per the illustration below.

**Penetration opening:** The annular space on each side of the wrapped duct shall be a maximum of 1-inch. The duct must be located centrally within the opening. The maximum area of the opening of the floor-ceiling-wall assembly is 1792 square inches, with a maximum opening dimension of 56 inches.

**Duct material:** The grease duct must be wrapped with the blanket material as per the enclosure instructions of this guide, and must be continuous through the opening.

**Packing material:** The annular space is to be tightly packed with nominal 4-pcf mineral wool. Packing material shall be recessed from the top surface of floor or both surfaces of the wall as required to accommodate the .25" thickness of Firestop sealant.

**Sealant material:** GE Silicone Pensil 300 is applied over the packing material, fully covering the packing to a minimum depth of .25".



ER-6066

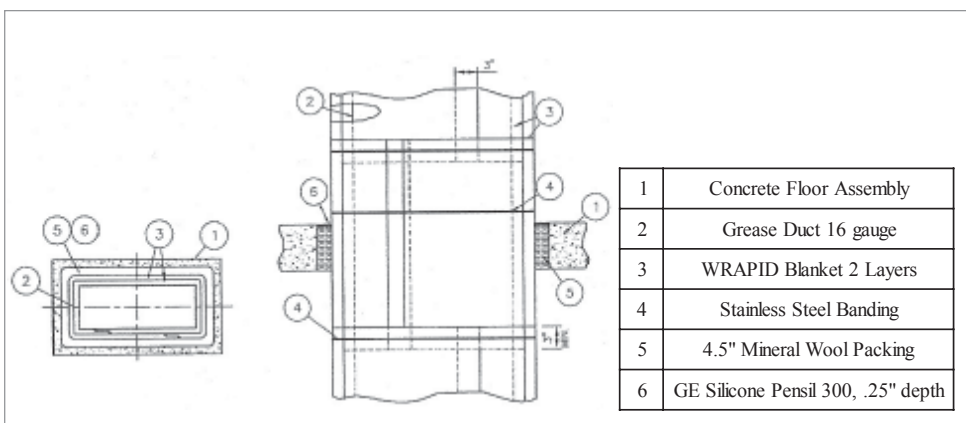

# ICBO

**ETS Schaefer**